

Dead Centres with Seal Diameters  
for **Mazak** Machines with Sleeve Sealing

## Tool Steel Dead Centres with seal diameters for Mazak Machines with sleeve sealing



### Form 255 – 257 – 258

Interchangeable dead centres, made from high quality tool steel, through-hardened, with seal diameters, draw-off threads and spanner flats. Maximum runout 0.004 mm.

Special designs available on request.

Form	Morse taper	ID.No.	D	G	SW	LC	L	Draw-off nut	Price
255	4	2554-190DL	31.6	M 35x1.5	27	87.5	190	M35DL	CALL
	5	2555-250DL	44.7	M 50x1.5	41	120.5	250	M50DL	CALL

**Form 255**  
similar to DIN 807, 60°

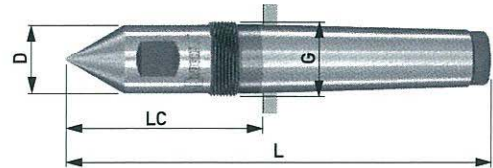

Form	Morse taper	ID.No.	D	d2	G	SW	LA	LC	L	Draw-off nut	Price
257	4	2574.13-190DL	13	31.6	M 35x1.5	27	27	87.5	190	M35DL	CALL
	5	2575.13-250DL	13	44.7	M 50x1.5	41	27	120.5	250	M50DL	CALL

**Form 257**  
slim design 60°/35°

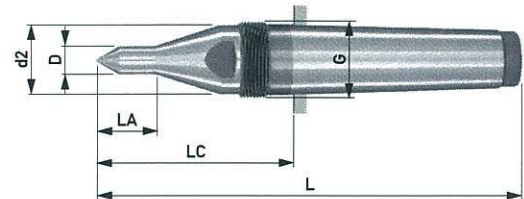

Form	Morse taper	ID.No.	D	d	G	SW	LC	L	Draw-off nut	Price
258	4	2584.80x20DL	80	20	M 35x1.5	36	97.5	200	M35DL	CALL
		2584.125x65DL	125	65	M 35x1.5	36	97.5	200	M35DL	CALL
	5	2585.80x20DL	80	20	M 50x1.5	55	100.5	230	M50DL	CALL
		2585.125x65DL	125	65	M 50x1.5	55	100.5	230	M50DL	CALL

**Form 258**  
bullnose centre 60°

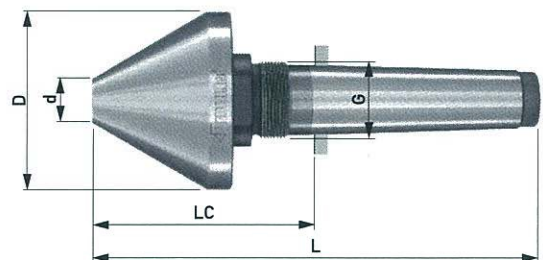

Draw-off nut with anti rotation					
ID.No.	G	LM	DM	SG	Price
M35DL	M 35x1.5	11	55	M5	CALL
M50DL	M 50x1.5	13	75	M5	CALL

**Draw-off nut with anti rotation**  
nut similar to DIN 1804 with thread for locking pin

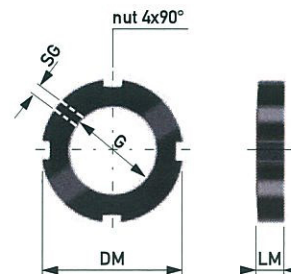

Karl Bruckner GmbH  
Präzisionswerkzeugfabrik

Exclusively Distributed by:

**POWERHOLD**

www.POWERHOLDINC.com

Phone: (800) 349-1044  
Fax: (860) 349-1815  
sales@powerholdinc.com  
www.powerholdinc.com